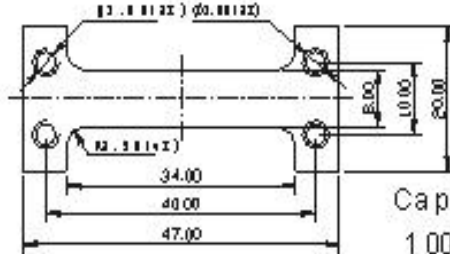
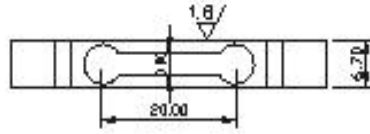

Model FAP—47*20*6

Material: Aluminum
Outline:

 Capacity:
 100, 200, 300, 500, 1000g

Specifications

Comprehensive Error	0.03 (FAP-47*20*6-1)	0.02 (FAP-47*20*6-2)
Output Sensitivity (mV/V)	0.8 ± 0.15	
Nonlinearity (%F.S)	± 0.03	± 0.02
Repeatability (%F.S)	± 0.03	± 0.02
Hysteresis (%F.S)	± 0.02	± 0.02
Creep (%F.S/3min)	± 0.02	± 0.02
Zero Drift (%F.S/1min)	± 0.03	± 0.03
Temp. Effect on Zero (%F.S/10°C)	± 0.1	
Temp. Effect on Output (%F.S/10°C)	≤ 0.03	≤ 0.02
Zero Output (mV/V)	± 0.1	
Input Resistance (Ω)	1050 ± 50	
Output Resistance (Ω)	1000 ± 5	
Insulation Resistance (MΩ)	≥ 2000	
Excitation Voltage (V)	≤ 6	
Operation Temp Range (°C)	0--+50	
Overload Capacity (%F.S)	150	
Capacity (g)	100,200,300,500,1000	
Material	Aluminum alloy	
Protection	IP65	
Recommended Applications	Subminiature sensors-----pocket scale sensors	

Note: All Specifications Subject To Change Without Notice & Custom-made Products Are Available.